

Water Supplies Proving Equipment

D Testrohre

F Equipements d'alimentation en Eau



PROVING PIPES



A5 128

Body: Malleable Iron, Galvanized, Mild Steel, Noryl, ABS
Körper: Temperguss, verzinkt, Weichstahl, Noryl, ABS
Corps: Fonte malléable, galvanisé, Acier doux, Noryl, ABS

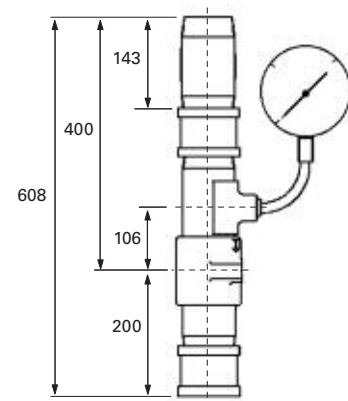

Art. Nr.	Hazard Group Gefahrengruppe Classe de risque	Inlet BSPT Male Eingang BSPT OG Entree BSPT Mâle	Outlet BSP Female Ausgang BSP IG Sortie BSP Taraudé	Gauge readings (Dm ³ /Min) Manometeranzeige Calibres jauge de débit		Kg	LPCB
01308	XLH	3"	3"	275	-	7.0	√
01309	OH1	3"	3"	375	540	7.0	√
01310	OH2	3"	3"	725	1000	7.0	√
01311	OH3	3"	3"	1100	1350	7.0	√
01312	OH3 Special	3"	3"	1800	2100	7.0	√
01313	XHH 7.5 mm/min	3"	3"	2300	-	7.0	√
01333	XHH 10 mm/min	3"	3"	3050	-	7.0	√



GAUGE

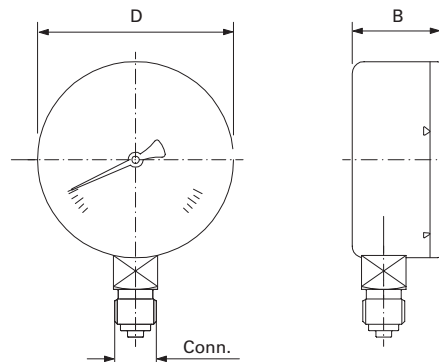

Art. Nr.	Connection Anschluß Connection	Meter Range Anzeigebereich Plage de mesure	Type Ausführung Type	Material Material Matériaux	D mm	B mm	Kg	UL	FM
025500013	1/4" NPT	0-300 Psi	Dry/Trocken/Sec	Black/Schwarz/Noir	94	46	0.4	√	√
2135338	3/8" ISO	0-16 Bar	Glycerin	St. Steel/Edelstahl/Inox	100	46	0.35		
7125411	1/2" ISO	0-16 Bar	Dry/Trocken/Sec	Steel/Stahl/Acier	100	46	0.4		
7125411G	1/2" ISO	0-16 Bar	Glycerin	St. Steel/Edelstahl/Inox	100	46	0.8		
7125411G63	1/4" ISO	0-16 Bar	Glycerin	St. Steel/Edelstahl/Inox	63	46	0.8		
7125438	1/2" ISO	0-16 Bar	Dry/Trocken/Sec	Steel/Stahl/Acier	100	46	0.4		
7125454	1/4" NPT	0-10 Bar	Dry/Trocken/Sec	Steel/Stahl/Acier	100	46	0.4		
2161086	1/2" ISO	-1-3 Bar	Glycerin	St. Steel/Edelstahl/Inox	100	50	0.8		
W01000110	1/2" ISO	0-25 Bar	Dry/Trocken/Sec	Steel/Stahl/Acier	100	46	0.4		
9296808*	1/2" ISO	0-16 Bar	Dry/Trocken/Sec	Steel/Stahl/Acier	100	46	0.6		

*Gauge also includes pressure switch/
 *Manometer mit Druckschalter/
 *Le manomètre comprend également le pressostat

Other options available on request/
 Andere Ausführungen auf Anfrage/
 Autres options disponibles sur demande